



ANCHOR 802-2 Snowman



Grade 3 padlock manufactured in all rust resistant materials. Suitable for locking toolboxes, lockers, trailers, power station switches and the like. The padlock is designed to be used with a Snowman cylinder. Delivered with shackle spring for pop up function as standard. As an option the padlock can be delivered with self-locking function or with weather protected version with concealed O-rings in the shackle holes.

- > Padlock body: 46mm brass
- > Shackle: 8mm stainless steel
- > Plating: Chrome
- > Cylinder type: Snowman
- > Shackle heights: 25, 60 and 110mm
- > Certification: Class 2 according to SSF 014 rev 3.
Grade 3 according to EN 12320:2012
- > Options: Self Locking (SL)
Weather protected (WP)
Brass Finish (BR)

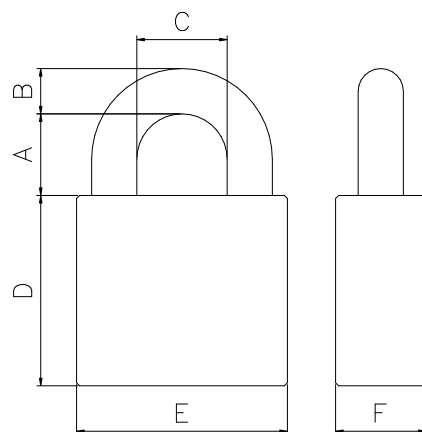

A	B	C	D	E	F
25/60/110	8	24	61	46	20